

Technical data sheet

3011-136C / KBS-EGT 10-60 20

(Status as of 15/01/2024)

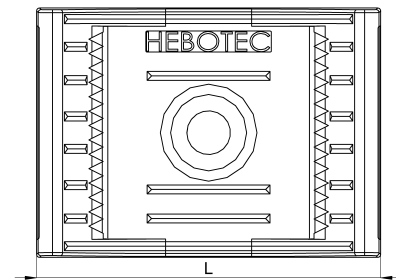
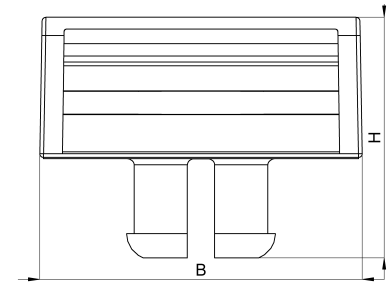

Design features

Dimensions (L / B / H) (mm)	36 x 26 x 19.4
Clamping range (mm)	10 - 60
Tape width (E) (mm)	20
Weight (kg)	0,007
Part	base
Material	polyamide glass fiber reinforced
Mounting type	EGT-profile
Colour	black

Order designation

Designation	Order No.	Description	PU
KBS-EGT 10-60 20	3011-136C	HEBOFIX base with clamping foot for aluminium profile EGT, clamping range 10-60mm, for hook-and-loop tape 20mm, according to UL94-V0	PU = 10 pcs.