

Technical data sheet

3011-004-180C / KBS-KE 8-35 20

(Status as of 15/01/2024)

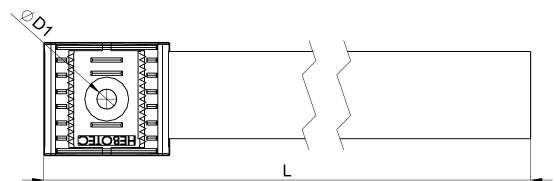
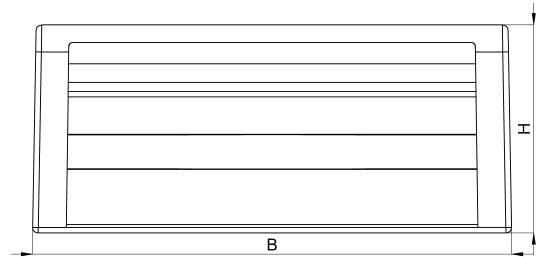
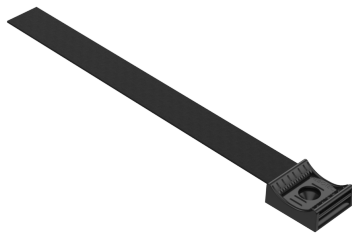

Design features

Dimensions (L / B / H) (mm)	209 x 26 x 11.3
Clamping range (mm)	8 - 35
Tape width (E) (mm)	20
Hole diameter D1 (mm)	4.3
Mounting hole 1	M4
Weight (kg)	0,007
Part	base
Part 2	hook-and-loop tape
Material	polyamide glass fiber reinforced
Material 2	polypropylene and velours PA

Mounting type	screw mounting
Colour	black

Order designation

Designation	Order No.	Description	PU
KBS-KE 8-35 20	3011-004-180C	HEBOFIX base for direct assembly, clamping range 8 - 35 mm, equipped with 180x20mm hook-and-loop tape for direct assembly, M4 and M5, according to UL94-V0	PU = 10 pcs.