

Technical data sheet

3011-001-150C / KBS-KE 4-20 7,5

(Status as of 15/01/2024)

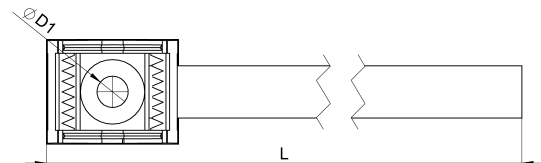
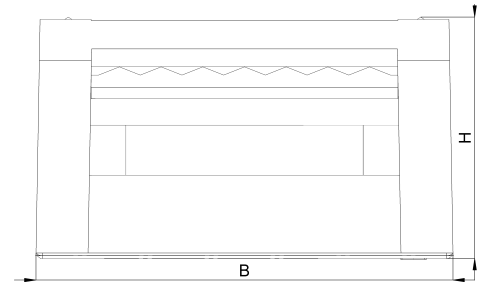
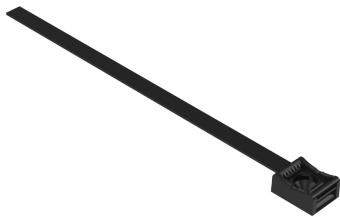

Design features

Dimensions (L / B / H) (mm)	168.6 x 15 x 8.6
Clamping range (mm)	4 - 20
Tape width (E) (mm)	7.5
Hole diameter D1 (mm)	4.3
Mounting hole 1	M4
Weight (kg)	0,002
Part	base
Part 2	hook-and-loop tape
Material	polyamide glass fiber reinforced
Material 2	polypropylene and velours PA

Mounting type	screw mounting
Colour	black

Order designation

Designation	Order No.	Description	PU
KBS-KE 4-20 7,5	3011-001-150C	HEBOFIX base for direct assembly, clamping range 4 20 mm, equipped with 150x7,5mm hook-and-loop tape, M4	PU = 10 pcs.