

Technical data sheet

1044-013F / ESE 15,5

(Status as of 26/06/2024)

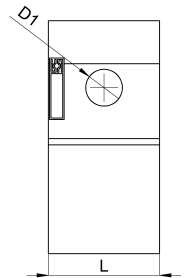
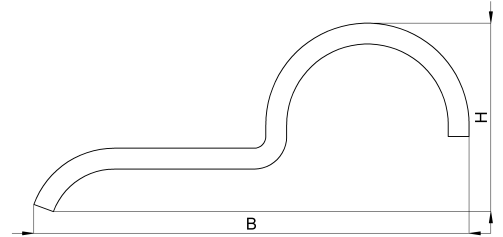

Design features

Dimensions (L / B / H) (mm)	20.1 x 41.7 x 18.1
Shield diameter min/max (mm)	13 / 15.5
Hole diameter D1 (mm)	6,3
Mounting hole 1	M6
Weight (kg)	0,016
Part	mounting bracket
Material	galvanized steel
Mounting type	screw mounting

Order designation

Designation	Order No.	Description	PU
ESE 15,5	1044-013F	Earthing clamp with 1 lug, clamping range 13.0 - 15.5mm, galvanised steel	PU = 100 pcs.