

Technical data sheet

1030-211C / SKHH 3 - 12

(Status as of 15/01/2024)

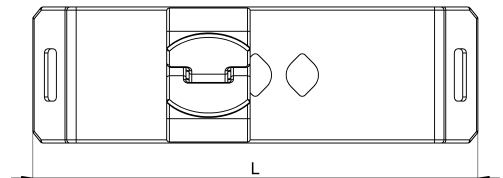
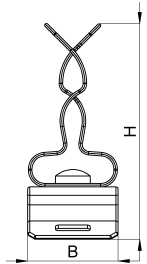

Design features

Dimensions (L / B / H) (mm)	42.1 x 13.1 x 31.1
Shield diameter min/max (mm)	3 / 12
Weight (kg)	0,006
Part	Shield clamp
Part 2	clip foot
Material	galvanized spring steel
Material 2	galvanized spring steel
Mounting type	DIN rail

Order designation

Designation	Order No.	Description	PU
SKHH 3 - 12	1030-211C	Staggered shield clamp on clip foot, for mounting onto 35mm DIN rails, clamping range 3 - 12mm	PU = 10 pcs.