

Technical data sheet

1030-204C / SKHH 8 - 11

(Status as of 15/01/2024)

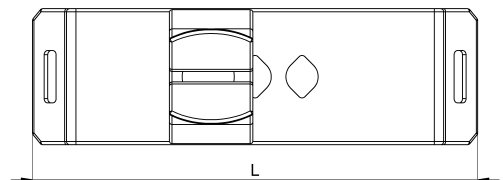
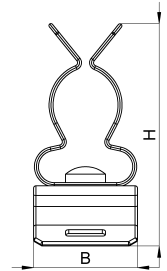

Design features

Dimensions (L / B / H) (mm)	42.6 x 13.1 x 27.8
Shield diameter min/max (mm)	8 / 11
Weight (kg)	0,006
Part	Shield clamp
Part 2	clip foot
Material	galvanized spring steel
Material 2	galvanized spring steel
Mounting type	DIN rail

Order designation

Designation	Order No.	Description	PU
SKHH 8 - 11	1030-204C	Staggered shield clamp on clip foot, for mounting onto 35mm DIN rails, clamping range 8 - 11mm	PU = 10 pcs.