

## Technical data sheet

1025-161C / HSE2 1,5 - 3

(Status as of 15/01/2024)

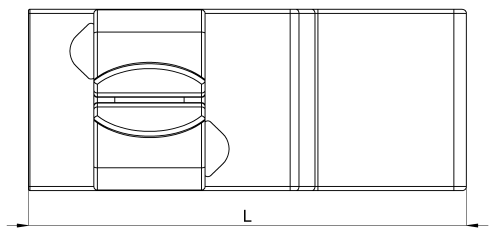
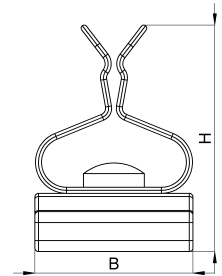

### Design features

|                              |                         |
|------------------------------|-------------------------|
| Dimensions (L / B / H) (mm)  | 31.5 x 13.1 x 18.6      |
| Shield diameter min/max (mm) | 1.5 / 3                 |
| Strain relief                | Yes                     |
| Weight (kg)                  | 0,005                   |
| Part                         | shield clamp            |
| Material                     | galvanized spring steel |
| Mounting type                | sheet edge 2mm          |

## Order designation

| Designation  | Order No. | Description   | PU           |
|--------------|-----------|---|--------------|
| HSE2 1,5 - 3 | 1025-161C | HEBOCLIP Uno for 10 x 2mm busbar or sheet metal edge, with shield clamp, shield diameter 1,5 - 3 mm | PU = 10 pcs. |