

Technical data sheet

1025-148C / HSE1,5 3 - 12

(Status as of 15/01/2024)

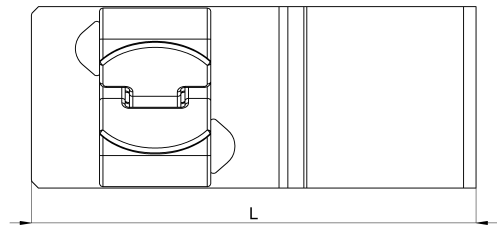
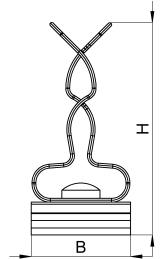

Design features

Dimensions (L / B / H) (mm)	31.9 x 13.1 x 27.7
Shield diameter min/max (mm)	3 / 12
Weight (kg)	0,005
Part	shield clamp
Material	galvanized spring steel
Mounting type	sheet edge 1.5mm

Order designation

Designation	Order No.	Description	PU
HSE1,5 3 - 12	1025-148C	HEBOCLIP Uno for 10 x 1,5mm busbar or sheet metal edge, without strain relief, with shield clamp, shield diameter 3 - 12 mm	PU = 10 pcs.