

Technical data sheet

1025-061C / HSD2 1,5 - 3

(Status as of 15/01/2024)

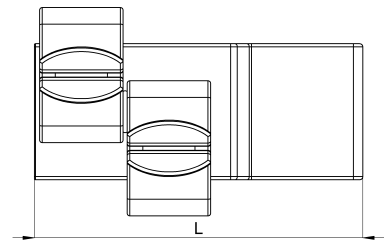
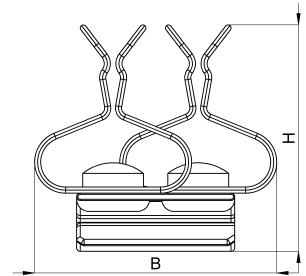

Design features

Dimensions (L / B / H) (mm)	31.5 x 19.9 x 18.6
Shield diameter min/max (mm)	1.5 / 3
Strain relief	Yes
Weight (kg)	0,007
Part	shield clamp
Material	galvanized spring steel
Mounting type	sheet edge 2mm

Order designation

Designation	Order No.	Description	PU
HSD2 1,5 - 3	1025-061C	HEBOCLIP Duo for 10 x2mm busbar or sheet metal edge, with 2 shield clamps, shield diameter 1,5 - 3mm	PU = 10 pcs.