

Technical data sheet

1025-044C / HSD1,5 3 - 12

(Status as of 15/01/2024)

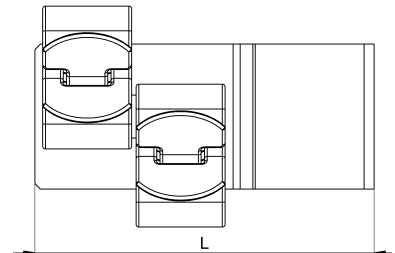
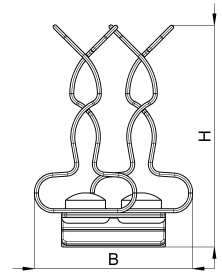

Design features

Dimensions (L / B / H) (mm)	32.1 x 19.8 x 27.7
Shield diameter min/max (mm)	3 / 12
Weight (kg)	0,010
Part	shield clamp
Material	galvanized spring steel
Mounting type	sheet edge 1.5mm

Order designation

Designation	Order No.	Description	PU
HSD1,5 3 - 12	1025-044C	HEBOCLIP Duo for 10 x1,5mm busbar or sheet metal edge, without strain relief, with 2 shield clamps, shield diameter 6-8mm	PU = 10 pcs.